

The End of Bad Wi-Fi

Jussi Kiviniemi
Ekahau



**2018 BICSI WINTER
CONFERENCE & EXHIBITION**
Orlando, FL | February 4-8

Bicsi

















About me

- Senior Vice President at Ekahau
- Product strategy & development
- Marketing strategy & evangelism

- Worked with Wi-Fi since 2001
 - At Ekahau since 2002

- *More info: Google "Jussi Wi-Fi"*



Find me on LinkedIn and Twitter:

Google: "Jussi Wi-Fi"



Agenda

- Cars
- Transportation system
- Practical examples



Wi-Fi is everywhere



Warehouses
rely on Wi-Fi



Hospitals
depend on Wi-Fi



Number #1 thing in
hotels:
Good Wi-Fi



No books at schools.
Just Wi-Fi

Bad Wi-Fi is everywhere



Warehouses grind to a halt when Wi-Fi fails

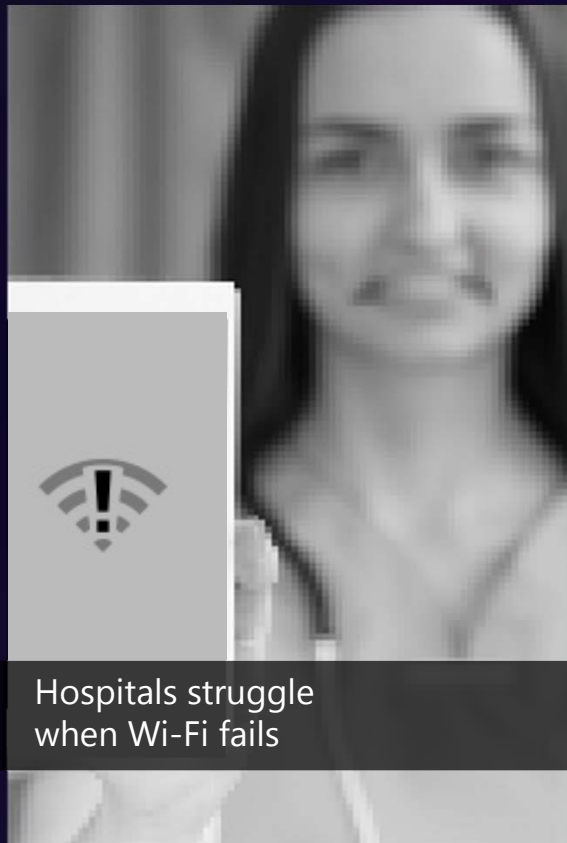

Hospitals struggle when Wi-Fi fails

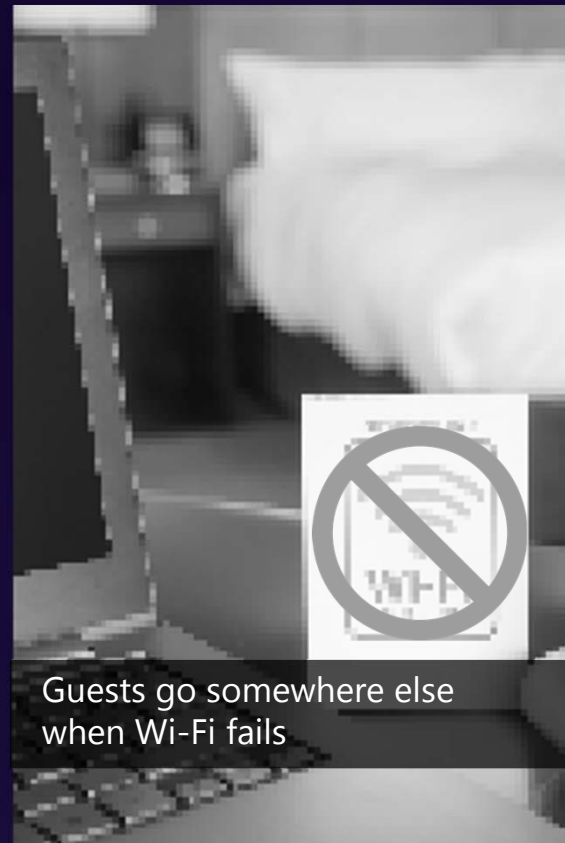

Guests go somewhere else when Wi-Fi fails

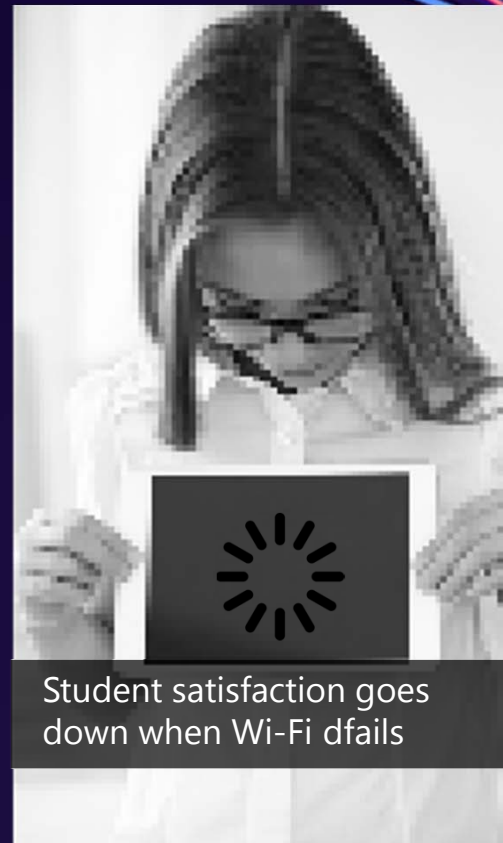

Student satisfaction goes down when Wi-Fi fails

Why does bad Wi-Fi exist?

Wi-Fi Network Life Cycle The Promise



Reality

DEPLOY

TROUBLESHOOT

EXPAND / REBUILD

RS COVERAGE HOLES ROAMING ISSUES
ERRORS INEFFICIENT AIRTIME USAGE
PACKET LOSS
CHANNEL OVERLAP CAPACITY PROBLEMS
INTERFERENCE CONFIGURATION ERRORS

Life cycle for Wi-Fi that works

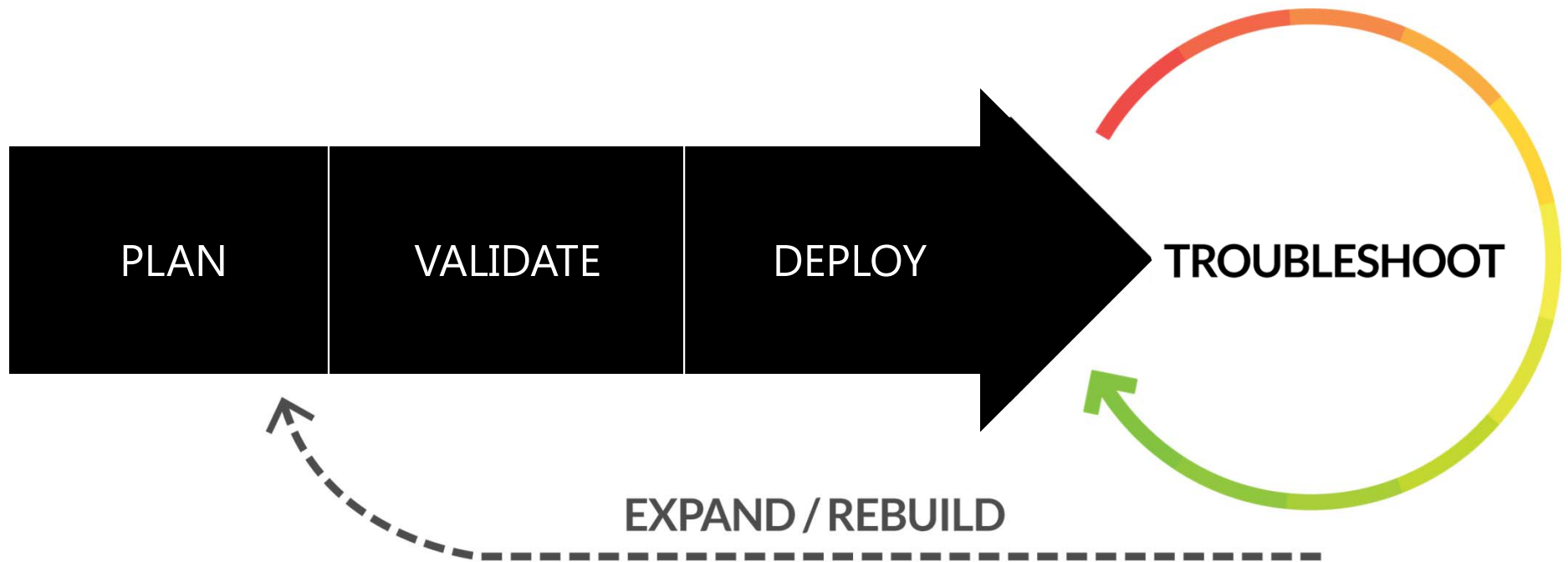

Bad Wi-Fi

- Problems connecting
- Choppy video
- Dropped calls
- Lost revenue
- Impacted healthcare services

Our mission



Great Wi-Fi

- Things just work



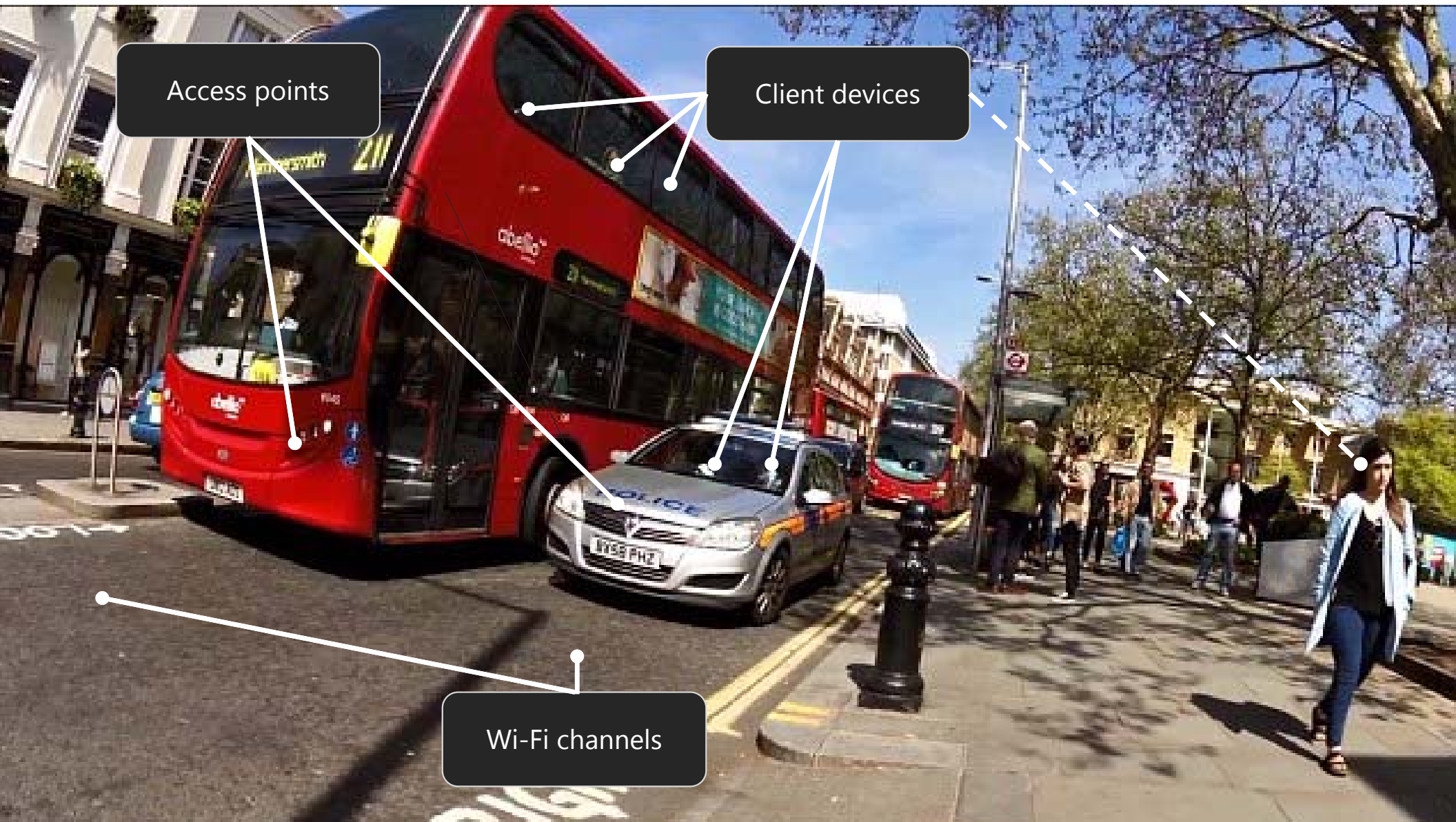

Access points

Client devices

Wi-Fi channels



Automatic RF functionality in access points is like Tesla's Auto-Pilot

- Transmit power optimization
- Channel optimizations
- Dynamic allocation of dual-5GHz

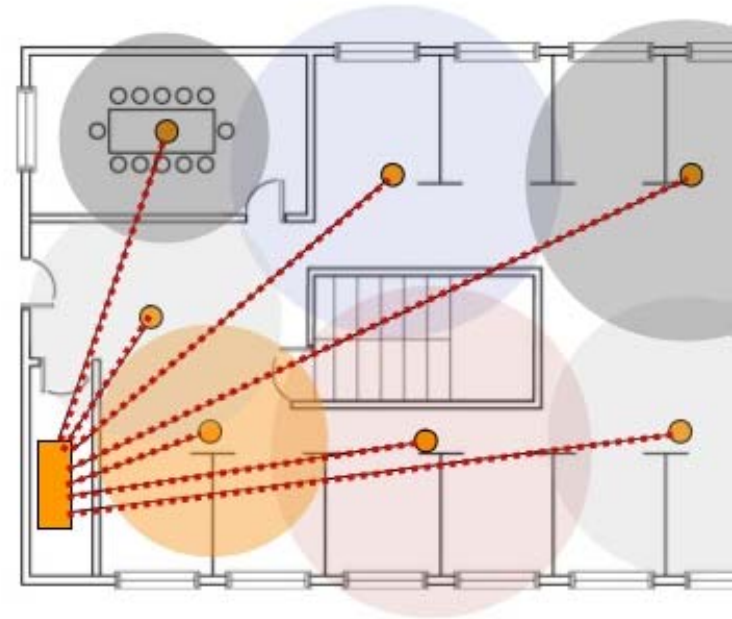

So, site surveys are not necessary.



Thank you!

Find me on LinkedIn and Twitter!

Google: "Jussi Wi-Fi"



**2018 BICSI WINTER
CONFERENCE & EXHIBITION**
Orlando, FL | February 4-8



Thank you!

NOT SO FAST

Find me on LinkedIn and Twitter!

Google: "Jussi Wi-Fi"



2018 BICSI WINTER
CONFERENCE & EXHIBITION
Orlando, FL | February 4-8





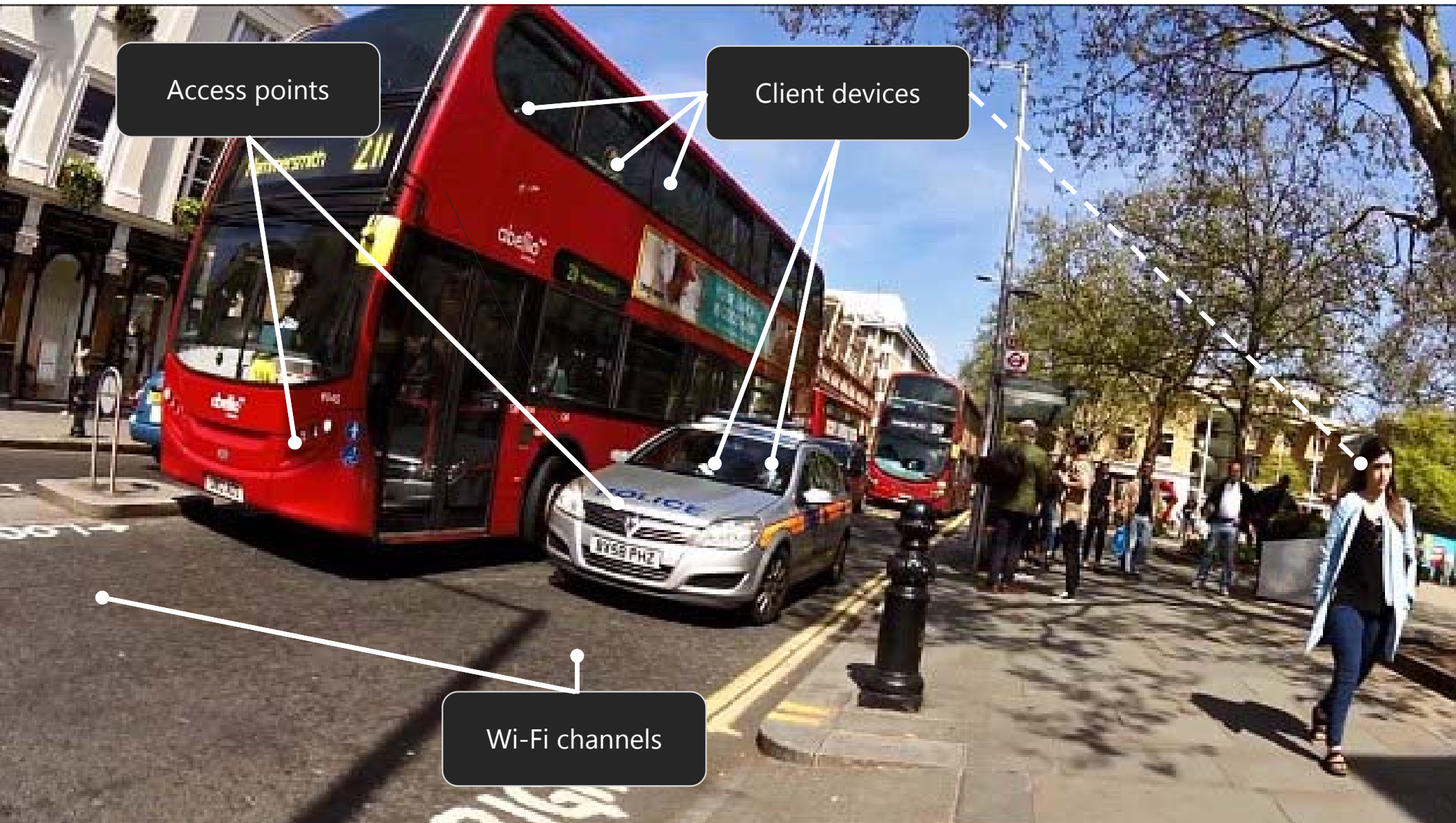

Access points

Client devices

Wi-Fi channels



















Let's take a closer look.

Each lane has limited capacity

- 3 channels on 2.4 GHz (1,6,11)
- 20+ on 5GHz (36-165)
- Use all the channels you can!



Two cars per lane is not better than one

- At any location...
- ... on any channel...
- ... **only use one access point!**
- Multiple access points on the same channel cause **co-channel interference**



The imbalance between the two highways

- 2.4 GHz frequency is often overutilized
 - Yet it only has 3 channels!
- Clients still tend to associate to 2.4 GHz radios
 - Received signal strength at the client device often higher on 2.4
 - Situation is improving



Oh, sheep!

- Wi-Fi devices play nice: they wait for their turn
 - 802.11 protocol
- Other devices don't understand 802.11, and do whatever they like
 - Microwave ovens
 - Cordless phones
 - Bluetooth
 - Video cameras
 - Baby monitors



Slow vehicles hurt everyone on the road

- Legacy client devices (802.11g, 802.11b) slow down everyone in your network

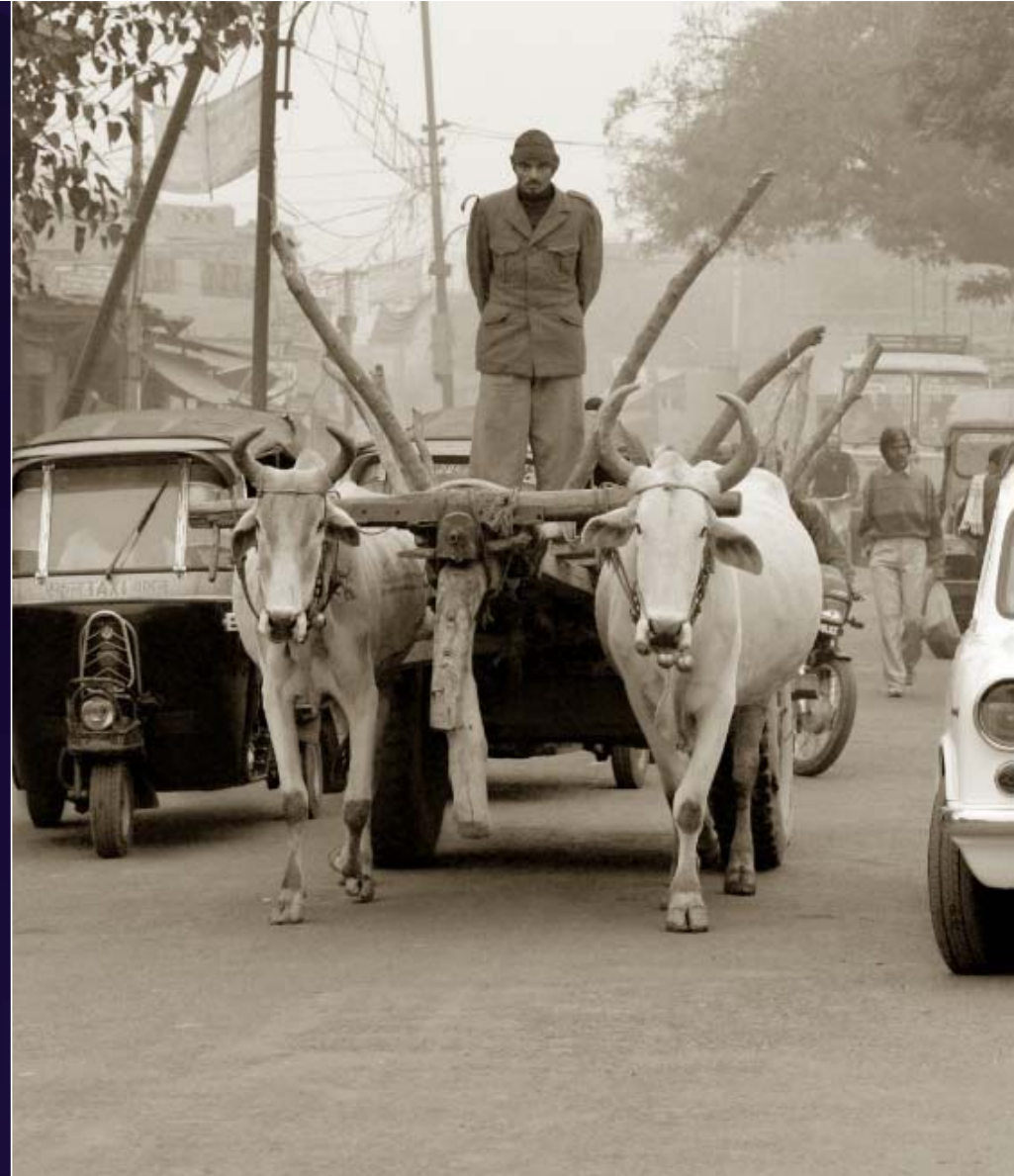

Minimum speed limits

- If you support the slowest data rates in your Wi-Fi network
 - Tons of overhead
 - Clients sticking to far away access points
 - Slower overall performance

MINIMUM

SPEED

50

Consider capacity

- Wi-Fi design is still often seen equal to coverage design
- Coverage is easy
- Your primary design goals in this decade should be
 - Minimal CCI
 - Capacity



The biggest mistake: Not planning at all

- Talk to stakeholders
 - Especially network users
- Account for main requirements
- Design carefully
- Take advantage of simulation
- Reserve time & \$ for on-site work



Auto-Pilot

- The Auto-Pilot is a great help
 - So is auto-RF in access points
- Best assistance is collision avoidance
 - Just like self healing is in the APs
- However
 - if the road has been badly designed...
 - ... or road conditions are bad...
 - ... auto-RF cannot solve the problem alone

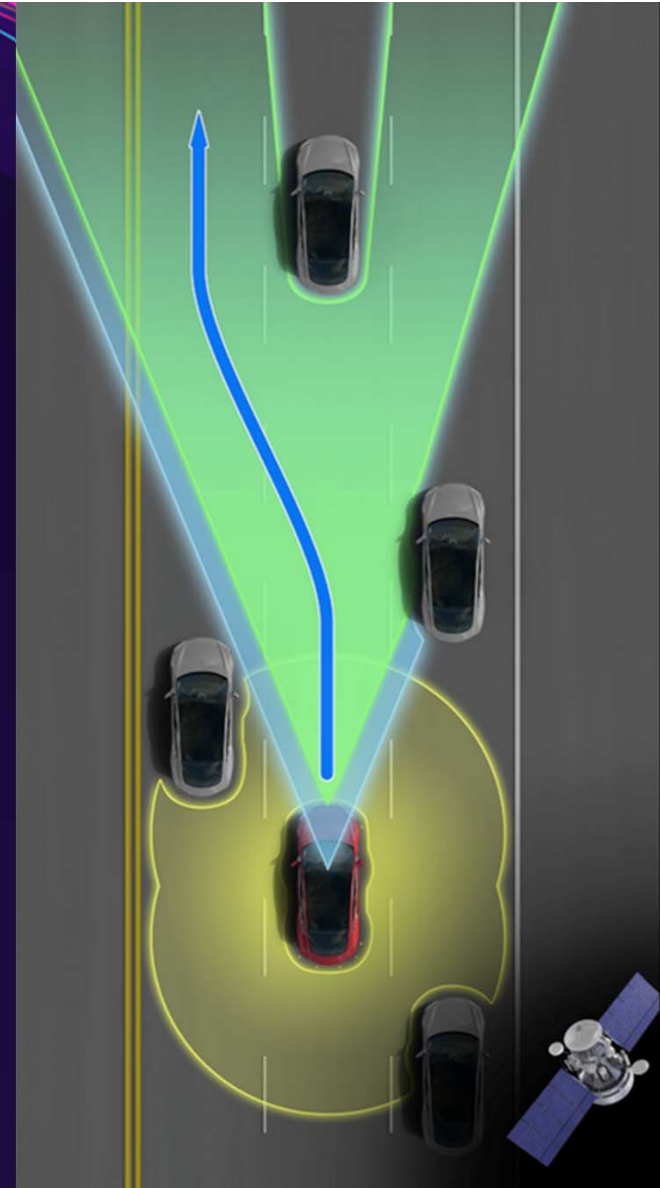

Be this guy... .. not this guy









Bicsi











#DiscoTrain



Your Wi-Fi network

- Like these gentlemen - does it stand out?
- In good or bad?



Practical examples



**2018 BICSI WINTER
CONFERENCE & EXHIBITION**
Orlando, FL | February 4-8





Thank you!

Find me on LinkedIn and Twitter!

Google: "Jussi Wi-Fi"



**2018 BICSI WINTER
CONFERENCE & EXHIBITION**
Orlando, FL | February 4-8

